

Ejector Coupler Solutions

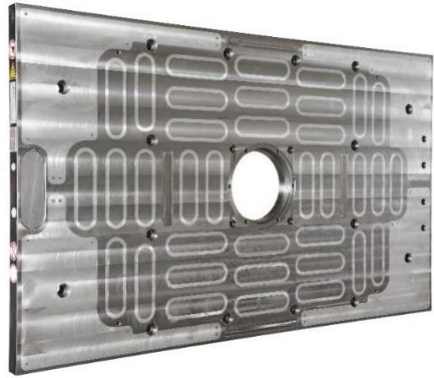

clamping solutions



ejector coupler solutions



couplers solutions

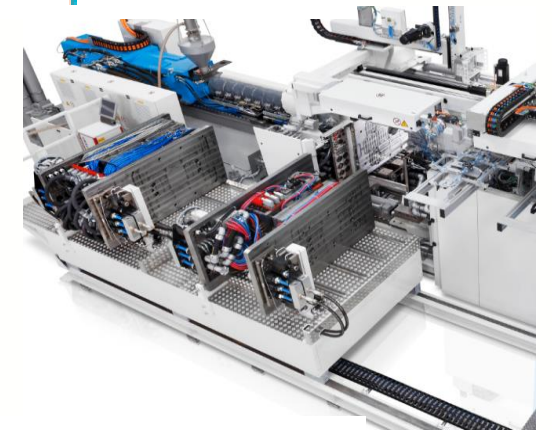

turnkey solutions



transport solutions



maintenance solutions



mold & die handling solutions

Automatic Ejector Couplers

- Automatic fast and reliable connection of mold ejectors – time saving
- High personal safety – no manual operation to connect ejector in the tight IMM ejector box .
- Automatic connecting, opening by hydraulic or pneumatic
- Open / Close position controlled
- For central ejectors and multiple ejector positions (Ejector Cross)
- For SPI and Euromap specification
- For retrofit or OEM setup
- For all Injection Molding Machine sizes
- For any IMM brand
- For any age of IMM

EAS Ejector Couplers

- **25 years experience** in building automatic ejector couplers
- Focus on **reliability** and **strong construction**
- Overall **rugged design** to maintain function at high push/pull forces and low cycle times
- Used in **fully automatic** mold change systems since decades
- Pneumatic operated coupler for **easy and fast retrofit**
- **Easy to maintain**, easy change of wear parts
- As only supplier we provide **impact resistant** ejector couplers which allows for a certain time a **boosted push / pull force**

EAS Ejector Couplers Application

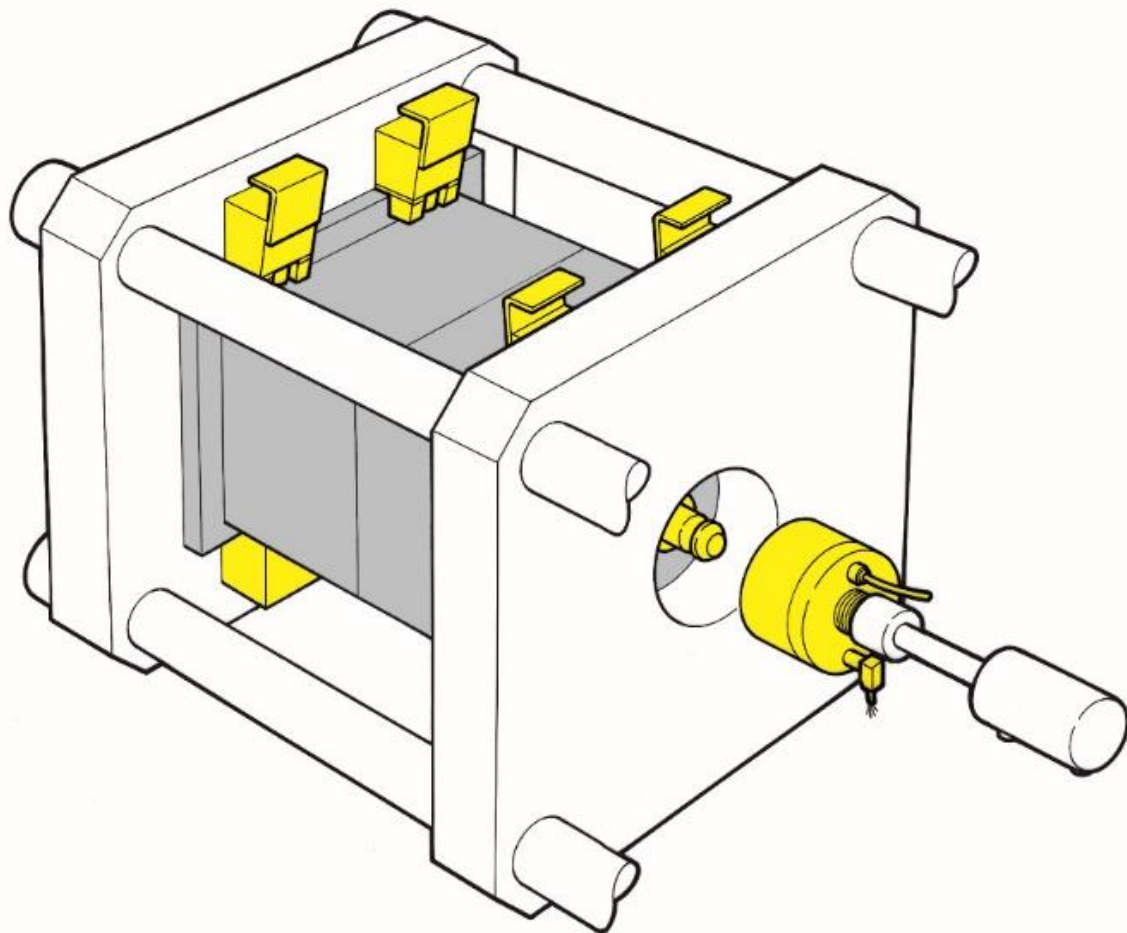

Central Ejector Solution

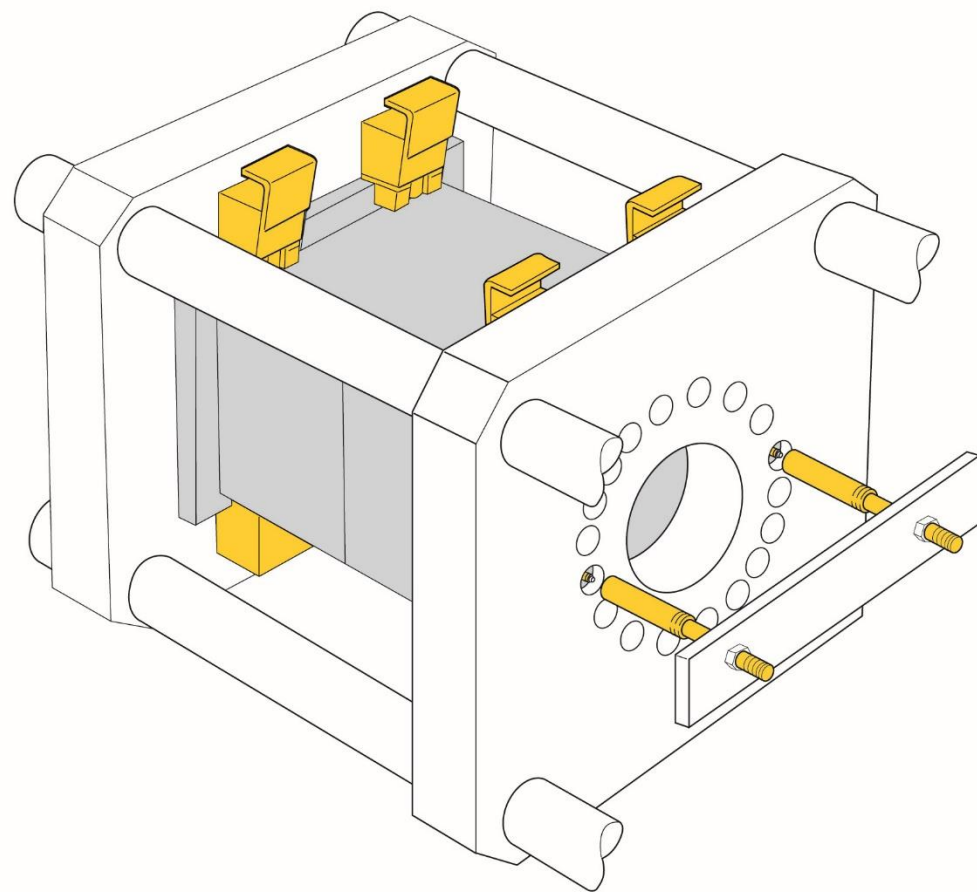

Multiple and SPI Ejector Solutions

Central Ejector Solution



Type **MCE** – Hydraulic operated Coupler
Type **MCA** – Pneumatic operated Coupler
Type **MEM** – Mold sided Coupler

Multiple and SPI Ejector Solutions



Type **WCE** – Hydraulic operated Coupler
Type **WEM** – Mold sided Coupler

MCE / A Ejector Couplers

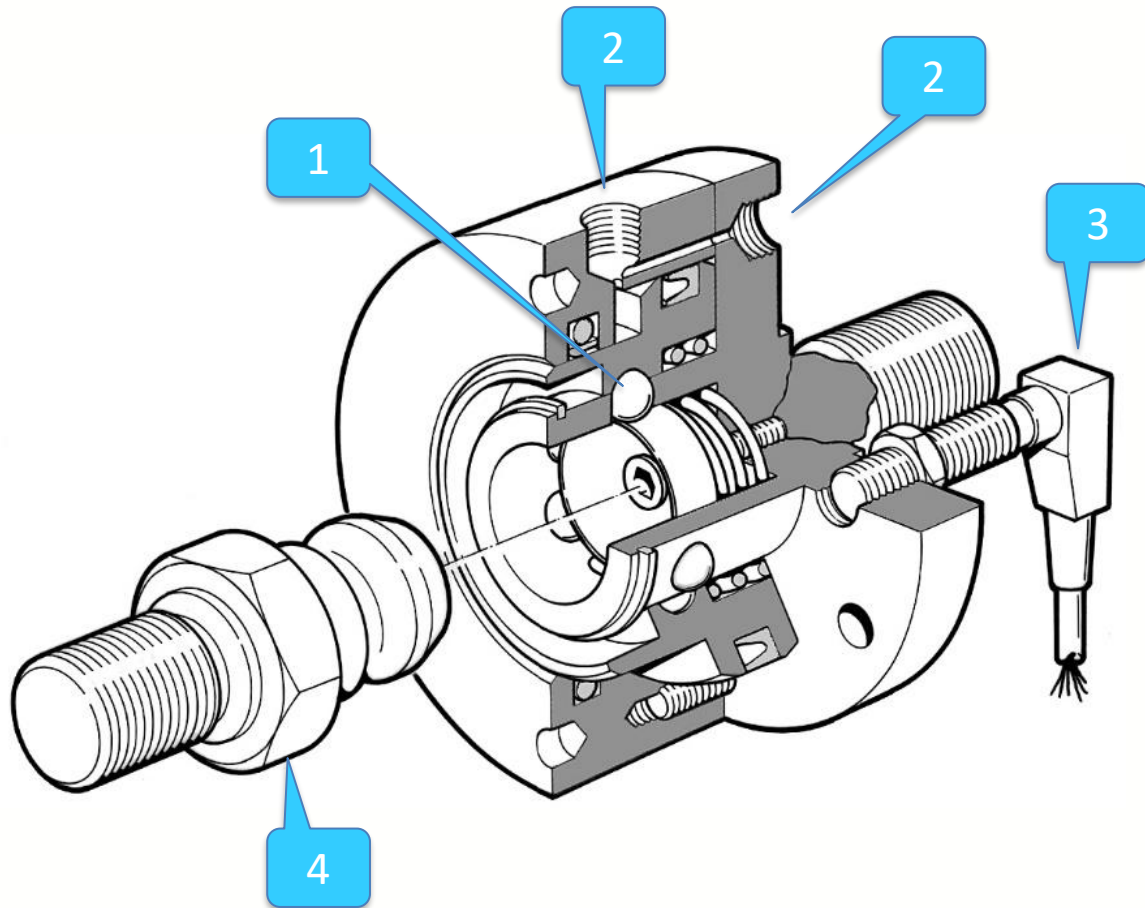

- Mechanical self locking (1)
- Ambient Temperature: 5 – 60° C
- Release Pressure :
 - Hydraulic 120 – 200 bar
 - Pneumatic 6 – 8 bar
- 2 ports to connect oil / air (2)
- 2 Proximity switches to detect closed and open position (3)
- Floating bearing of 1 mm to level mismatch between ejector rod and coupler
- Wear resistant mold ejector coupler (4)

WCE Ejector Couplers

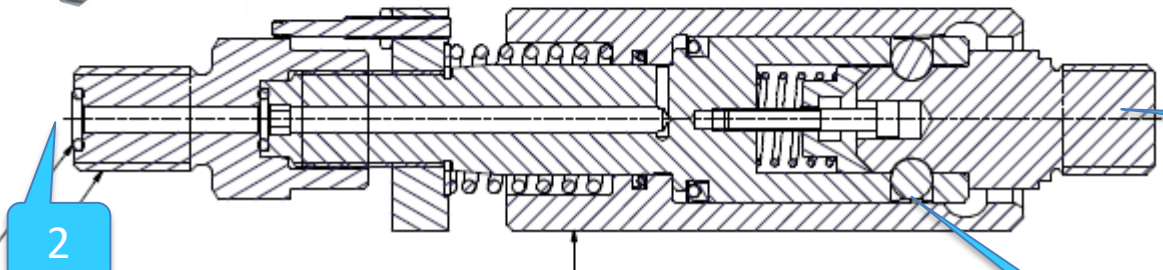
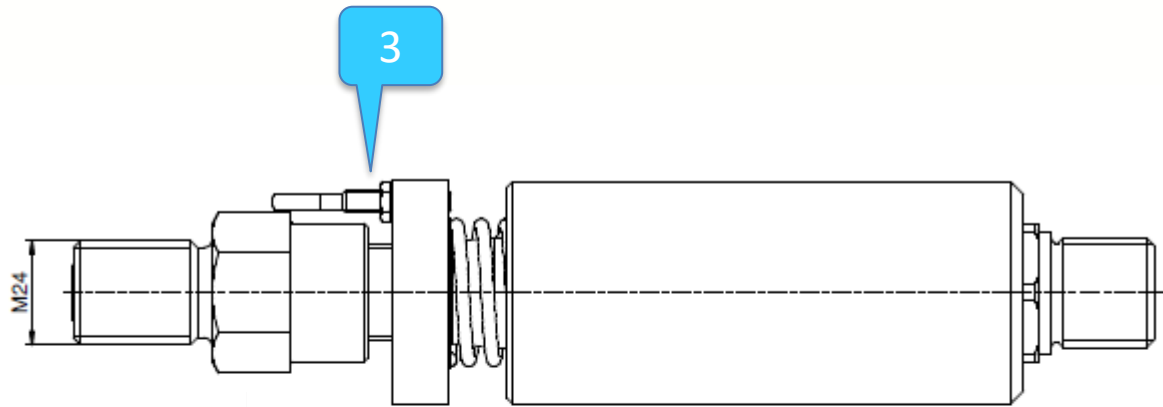

- SPI Size 1" and 2"
- Mechanical self locking (1)
- Ambient Temperature: 5 – 60° C (41-140°F)
- Release Pressure :
 - Hydraulic 90 – 210 bar (1300-3000 psi)
- Port to connect hydraulic circuit (2)
- Proximity switch to detect closed position (3)
- Floating bearing of 1 mm to level mismatch between ejector rod and coupler
- Wear resistant mold ejector coupler (4)

Ejector Coupler IMM Side

Type	Opening by	Ejector Push Force [kN]	Ejector Pull Force [kN]	Outer Diameter	Mounting Thread	Coupler Stroke to connect	Position Detection	Weight [kg]
MCE / MCA 21	Hydraulic Pneumatic	12 / 24 *	8 / 16 *	80 mm	M 16	22 mm	Open / Closed	2,0
MCE / MCA 51	Hydraulic Pneumatic	30 / 60 *	20 / 40 *	94 mm	M 20	26 mm	Open / Closed	4,0
MCE / MCA 101	Hydraulic Pneumatic	65 / 130 *	31,5 / 63 *	122 mm	M 24	39 mm	Open / Closed	8,5
MCE / MCA 201	Hydraulic Pneumatic	250	125 / 200 *	167 mm	M 36	48 mm	Open / Closed	21,0
WCE** / MCE 10	Hydraulic	12	10	1" / 25,4 mm	M 12		Open	0,5
WCE** / MCE 52	Hydraulic	60	49	2" / 51,3 mm	M 24		Open	2,0

* Incidental , max 50.000 cycles

** Imperial sized threads available

EAS Ejector Coupler in Detail

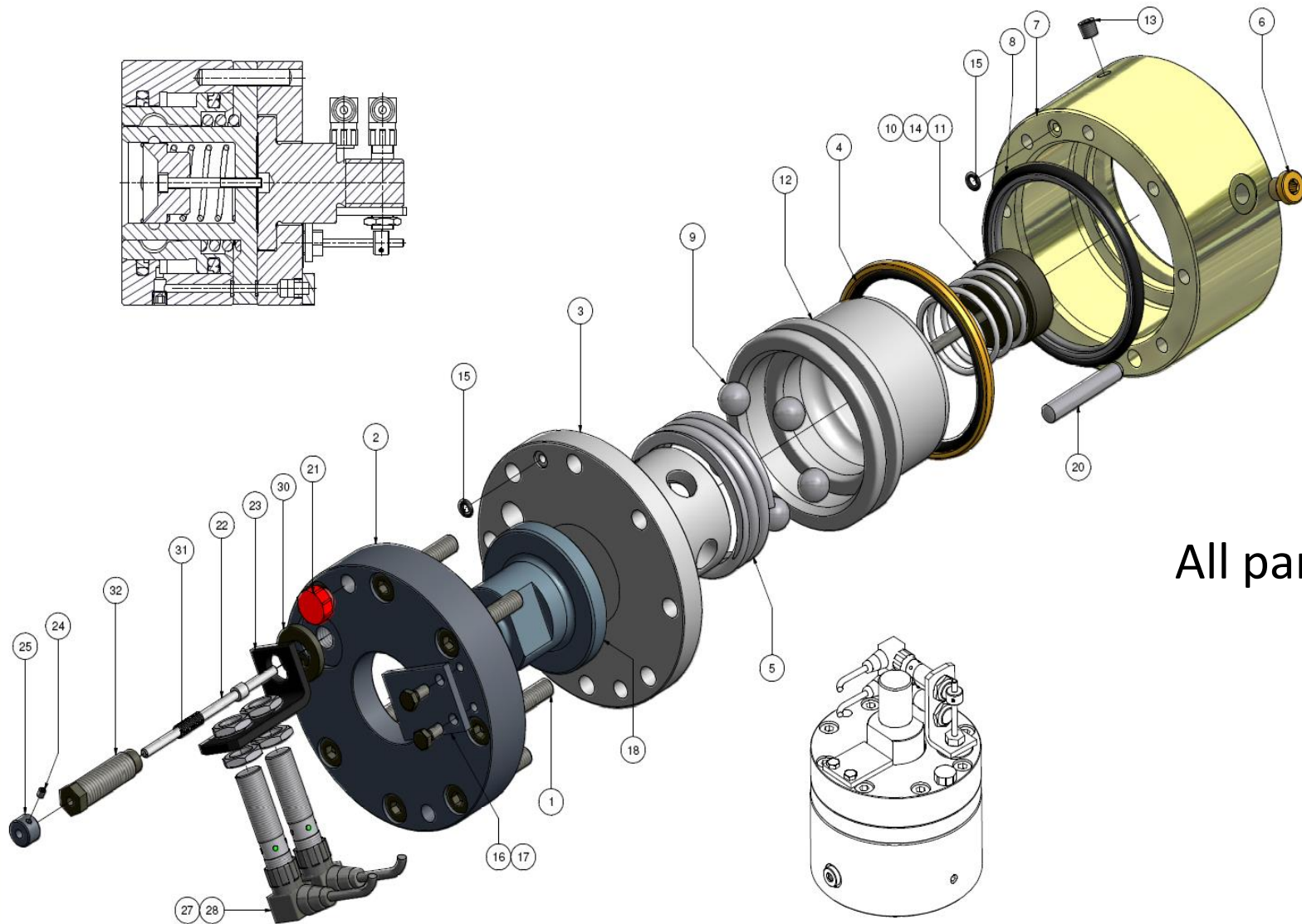

All parts exchangeable !

EAS Ejector Couplers at work

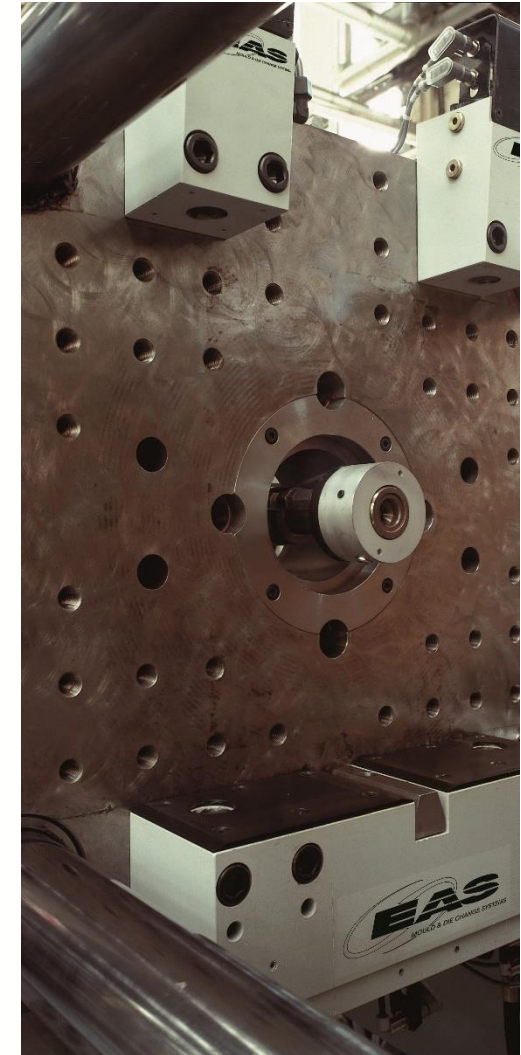
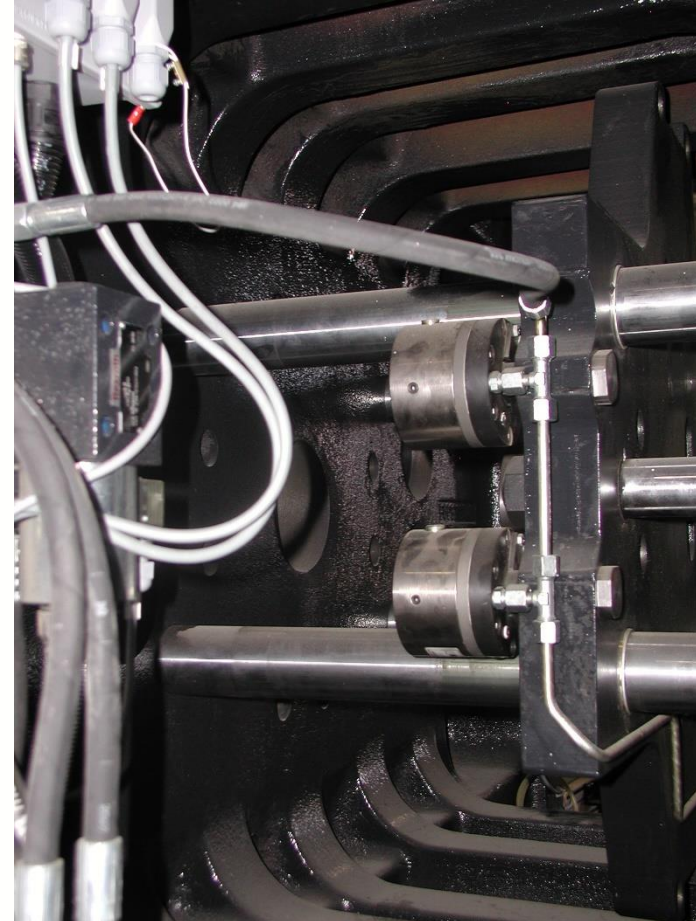
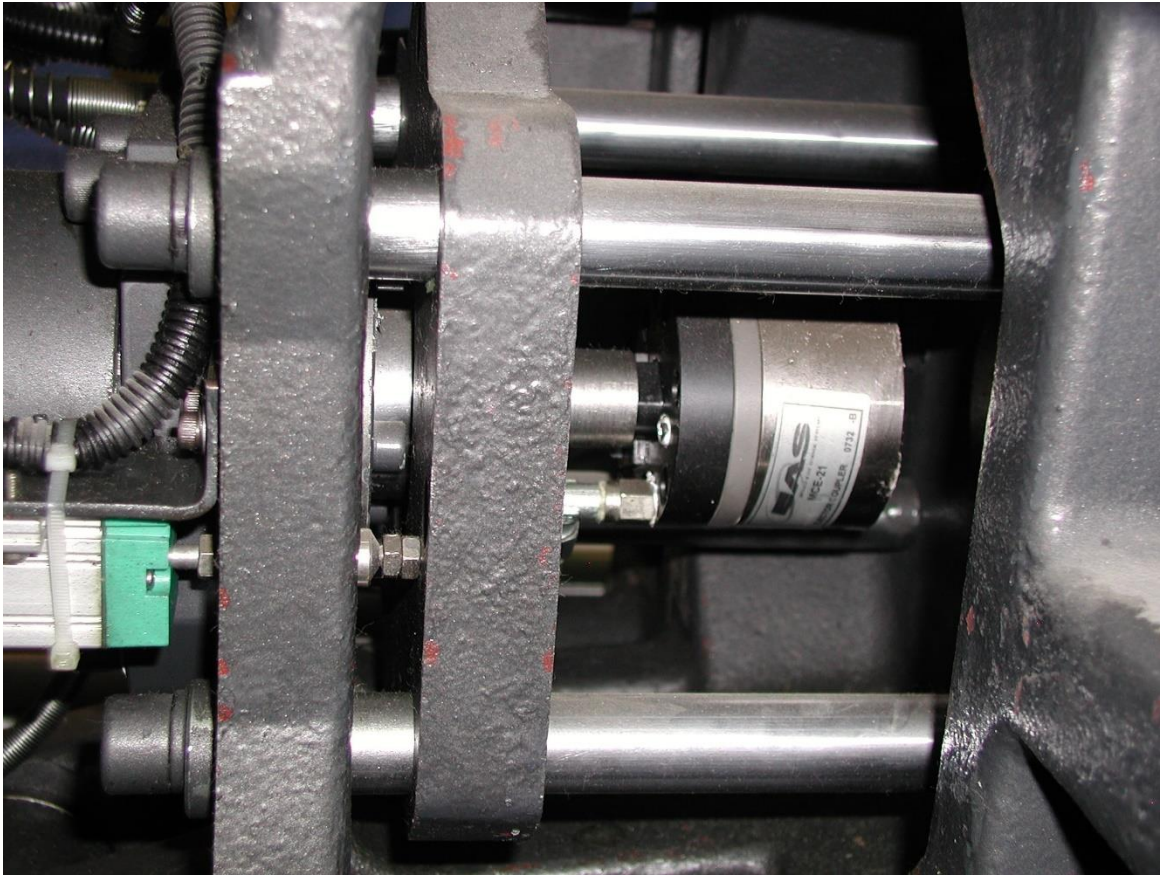

Hydraulic powered MCE Ejector Coupler mounted in IMM

EAS Ejector Couplers at work

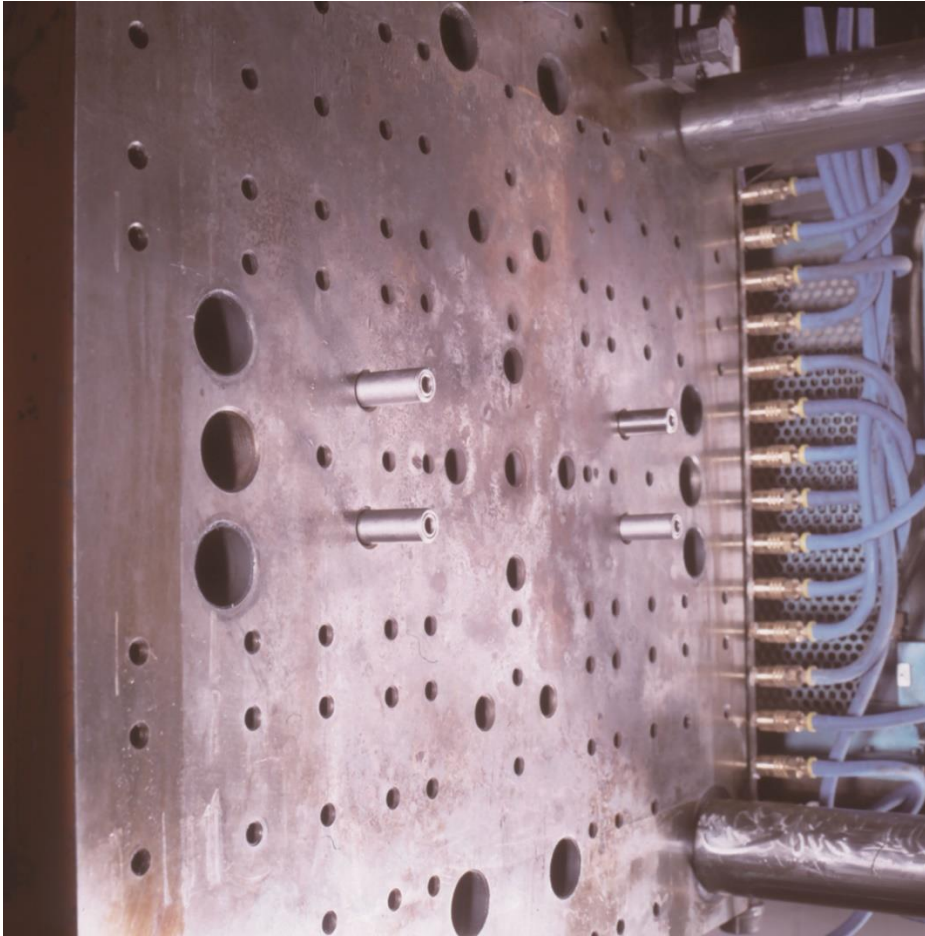

4 WCE Ejector Couplers mounted on ejector cross

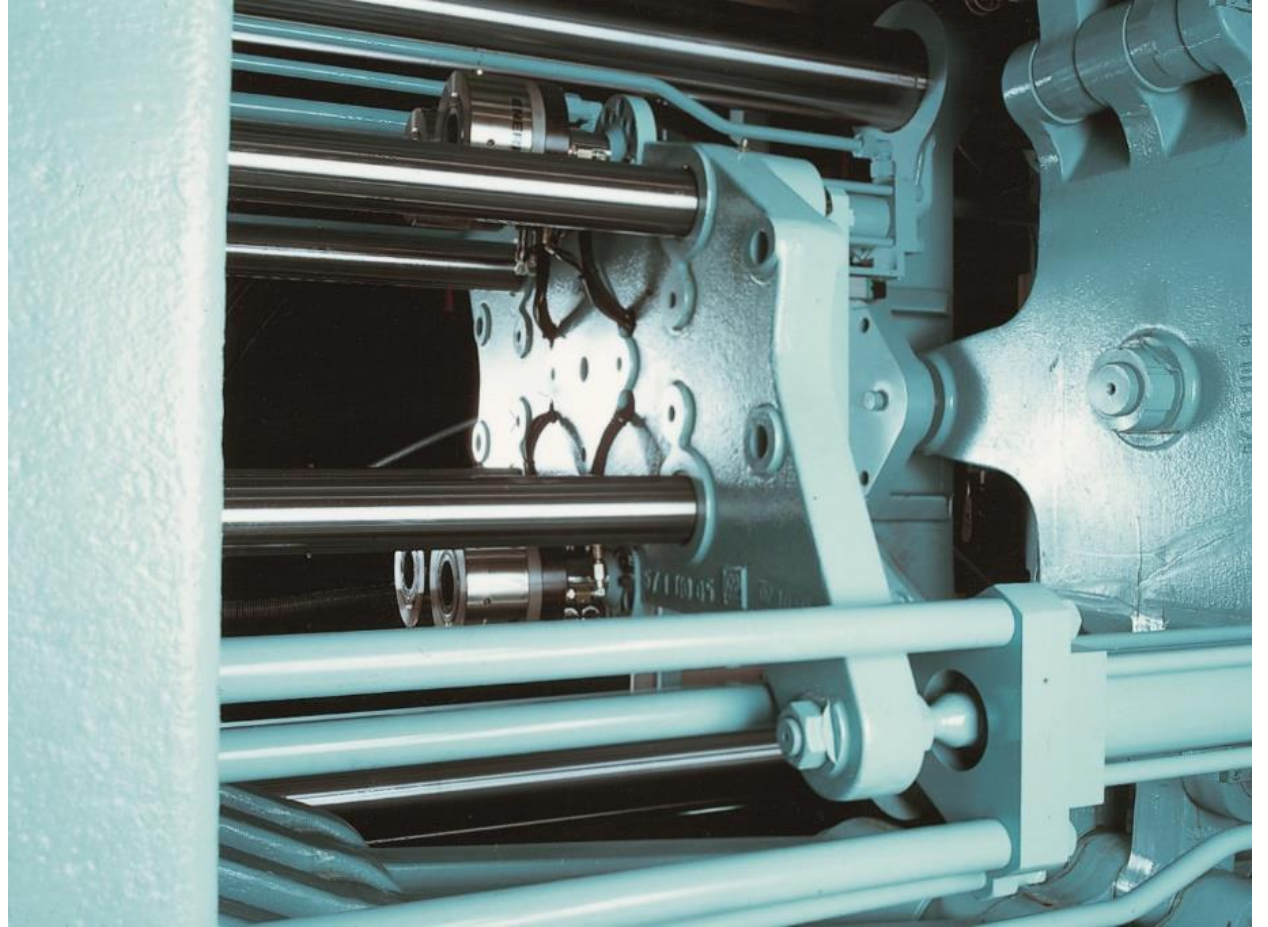

4 MCE Ejector Couplers mounted on ejector plate

Things to be taken care of

- Check Ejceter push and pull force of IMM
- Check ejector stroke needed - coupler needs space
- Check mounting space for the coupler
- Check hydraulic or pneumatic access
- Check ejector plate threads – we can adopt to coupler

- EAS Changesystems is a global, leading edge innovator in factory automation solutions.
- Thanks to EAS Changesystems the clamping and release of molds and dies has become a process of minutes instead of hours.
- EAS Changesystems offers quick clamping and quick changing systems for plastic injection molding machines (QMC) and metal stamping presses (QDC), as well as multi coupler solutions. The company also offers consulting and engineering expertise to ensure maximum machine productivity.

*no change,
no progress*



no change, no progress